

RTS11-ON-2U

1-3kVA PF=0,9









CE RoHS  VFI-SS-111

Features

<ul style="list-style-type: none"> • Pure sine output 	<ul style="list-style-type: none"> • Hot-swap – easy AGM batt replacement
<ul style="list-style-type: none"> • True online double conversion – topology VFI-SS-111 High-frequency 	<ul style="list-style-type: none"> • DSP control porcesor
<ul style="list-style-type: none"> • RACK 19" case 	<ul style="list-style-type: none"> • Input power factor – 0,99 • Output power factor – 0,9
<ul style="list-style-type: none"> • Voltage and frequency independent 	<ul style="list-style-type: none"> • Fan auto-regulated
<ul style="list-style-type: none"> • Battery auto-charge 	<ul style="list-style-type: none"> • New charger design, 90% capacity restore in 3hours
<ul style="list-style-type: none"> • Autodiagnostic, communication 	<ul style="list-style-type: none"> • Cold start
<ul style="list-style-type: none"> • User menu interface 	<ul style="list-style-type: none"> • Many transmission protocol

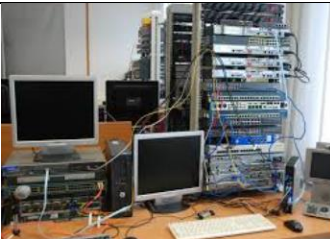
Typical application

		
Telecommunication systems	Servers	Industrial
		
Data center	Measurments	Drives

Technical parameters

MODEL	RTS11-ON-1k0-2U-2x9	RTS11-ON-1k0-2U-3x7	RTS11-ON-2k0-2U-4x9	RTS11-ON-1k0-2U-6x7	RTS11-ON-3k0-2U-6x9
Rated power (reactive/active)	1000VA/900W		2000VA/1800W		3000VA/2700W
INPUT					
Input voltage	Rated: 230VAC (208V / 220V / 230V / 240V) Input voltage range: 176Vac – 280Vac Bypass: -25%...+15% rated				
Input voltage frequency	40-70Hz Autoselection				
Power factor	PF >0,99				
Connector:	IEC C14			IEC C20	
OUTPUT					
Output voltage	Mains mode: 230Vac +/- 1%, Battery mode: 230Vac +/- 1%, Other settings: 208V, 220V, 240V				
Output voltage frequency	50/60Hz ± 1% (auto selection)				
Wave form	Mains mode: pure sine Battery mode: pure sine				
Transfer time	Mains -> battery: 0ms To bypass: 4ms				
THD	THD <2% linear THD <5% non-linear				
Output sockets	IEC C13 6pcs	IEC C13 8pcs		IEC C13 8pcs	
Efficiency	Mains mode: >90% Battery mode: >85% ECO mode: >95%	Mains mode: >91% Battery mode: >86% ECO mode: >96%		Mains mode: >92% Battery mode: >87% ECO mode: >97%	
PF	0,9				
Crest factor	3:1				
Load type	Resistance, inductor, rectifier				
Overload protections	105%...125%: transfer to bypass after 1min 125%...150%: transfer to bypass after 30sek >150%: transfer to bypass after 300ms				
BATTERY					
Type:	Lead-acid VRLA AGM, voltage 12V				
Charger current:	1A				
Montage:	Hot-swap case on front panel				
Battery q-ty :	2 x 9Ah12V	3 x 7Ah12V	4 x 9Ah12V	6 x 7Ah12V	6 x 9Ah12V
Battery model:	IPSH 9-12L MWH 9-12L	IPS 7.2-12L MWL 7.2-12L	IPSH 9-12L MWH 9-12L	IPS 7.2-12L MWL 7.2-12L	IPSH 9-12L MWH 9-12L
Charger voltage:	24Vdc	36Vdc	48Vdc	72Vdc	72Vdc
Charger time:	3-5h				

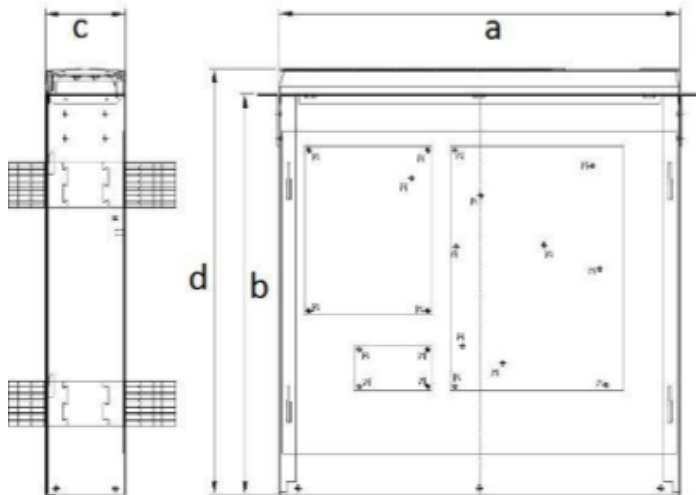

MODEL	RTS11-ON- 1k0-2U-2x9	RTS11-ON- 1k0-2U-3x7	RTS11-ON- 2k0-2U-4x9	RTS11-ON- 2k0-2U-6x7	RTS11-ON- 3k0-2U-6x9
Rated power (reactive/active)	1000VA/900W		2000VA/1800W		3000VA/2700W
BACKUP TIME					
Backup for 100% load	2min	3min	2min	3min	2min
Backup for 75% load	5min	6min	5min	7min	4min
Backup for 50% load	9min	12min	9min	13min	7min
Backup for 25% load	21min	25min	25min	25min	21min
Additional battery pack:	1szt KU-BAT- 2URT-2x9-BC24	1szt KU-BAT- 2URT-3x7-BC36	1szt KU-BAT- 2URT-4x9-BC48	1szt KU-BAT- 2URT-6x7-BC72	1szt KU-BAT-2URT-6x9- BC72
DIMMENSION & WEIGHT					
Weight netto/brutto (kg)	11,1 / 14,4 kg	13,8/17,3 kg	21,4/25 kg	27,2/31.3 kg	30,6/34,7 kg
Dimmension w/d/h. (mm) a/b/c	440/368/88 mm	440/468/88 mm	440/528/88 mm	440/728/88 mm	440/728/88 mm
Package w/d/h (mm)	545/492/198 mm	545/592x198 mm	545/652/198 mm	545/852/198 mm	545/852/198 mm
ALARMS					
Fail	Long beep 4 sek				
Low battery level	beep 1 sek				
Protections	2x beep / 1sek				
Utility error	beep				
PROTECTIONS					
Full protection	Overload, short-circuit, overvoltage, temperature, overdischarge, deep discharge				
Sockets	Modem / Tel /Fax				
ENVIRONMENT					
Humidity	20~90% RH @ 0~40°C (non-condensated)				
Noise	Fan rotation auto-selected				
COMMUNICATION					
Port USB (w standardzie) Port RS232 (w standardzie)	Linux, Windows®98 Server 2016, and Windows®98/2000/2003/XP/Vista/2008/Windows®7/Windows®8/ Windows®10/, UPSmart software				
Slot na kartę rozszerzeń: (jedno miejsce)	KU-CARD-SNMP, Ethernet communications				
	KU-CARD-AS400, dry contacts				
	KU-CARD-MODBUS, modbus				
EPO (w standardzie)	Wejście EPO – Emergency Power OFF				
STANDARDS					
Conversion type:	VFI-SS-111				
LVD:	EN62040-1:2008				
EMC:	EN62040-1:2008 + A1:2013				
	EN61000-3-2:2014				
	EN61000-3-3:2013				

DIMMENSIONS:

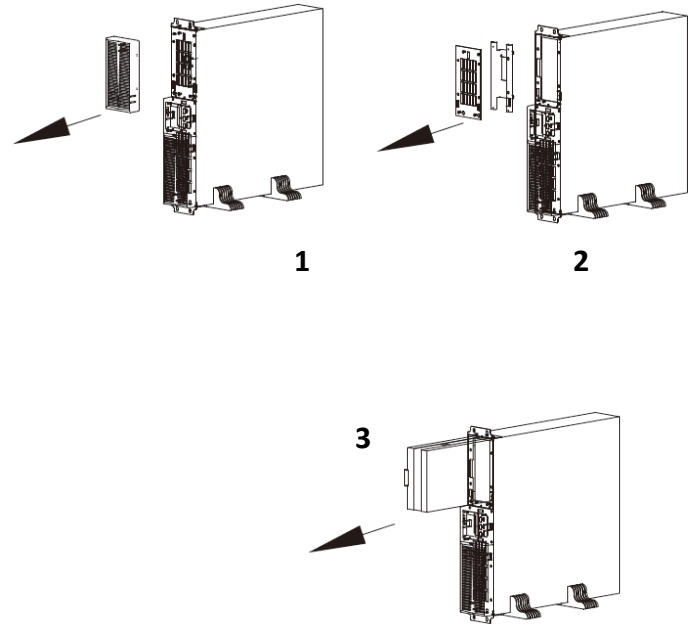

Batteries Hot-Swap:



MODEL	RTS11-ON-1k0-2U-2x9	RTS11-ON-1k0-2U-3x7	RTS11-ON-2k0-2U-4x9	RTS11-ON-1k0-2U-6x7	RTS11-ON-3k0-2U-6x9
EAN					
Rear panel					

1	Mains braker	6	Fan
2	Input socket	7	RS232
3	Modem/tel/fax surge protection	8	EPO
4	External battery socket	9	USB
5	Output sockets IECC13	10	Empty slot for cards